



Savio Engineering, Inc.
8 Water Garden Way
Santa Fe, NM 87508 USA
<http://www.savio.cc> • email: support@savio.cc

Innovative, precision engineered solutions

Advanced water gardening products for healthy, clean living ponds.



Skimmerfilters™



Livingponds Filters™



Pond Packages



Ultraviolet Clarifiers



Water Master Pumps™



Automated Water Level Sensor™



Springflo Bio Filter Media™



Greenex® Micro Granules



Aqua Flex PVC™



Black Foam



Water Treatments



K1003

Mechanical Water Leveler

for use with the SAVIO Skimmerfilter™

Operating Manual & Installation Guide

Read entire instructions prior to assembly and operation.



4-6-SV-04

Not suitable for use with Compact Skimmerfilters.™

Operating Capacities

The SAVio Mechanical Water Leveler Kit™ is specifically designed to operate with the SAVio Skimmerfilter™. This kit will provide a regulated flow of water to maintain optimal water level and can be connected to copper, plastic or iron water supply lines up to 1" in diameter.

Components:

- Mini-Float Valve
- Baffle Shield
- Self Tapping Hose Kit



Tools needed:

- Phillips Screwdriver
- Crescent Wrench or Pliers

If the SAVio Skimmerfilter™ is in operation, turn off the pump and unplug UV before installing this kit.

Assembly and Installation

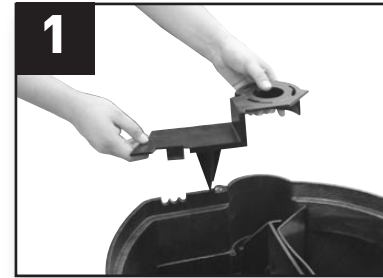

1 Remove existing baffle shield from Skimmerfilter™. Save screws for later.

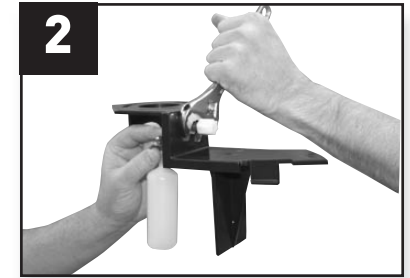

2 Tighten thumb screw on float valve so that valve hangs at a 90° angle. Tighten white nut to secure float valve.

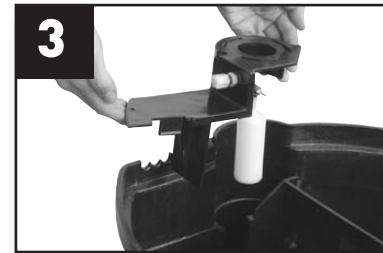

3 Install water leveler assembly. Use screws from Step 1 to secure.

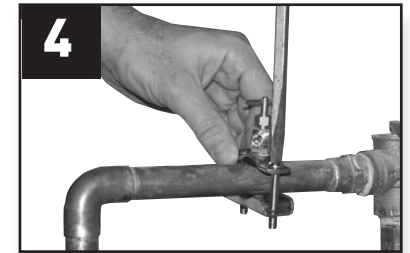

4 Turn off water source. Attach self tapping hose kit to water line. Follow instructions included with hose kit. Extra fittings have been included to allow for greater versatility.

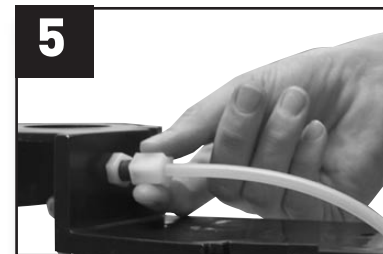

5 Connect hose to Water Leveler Kit.

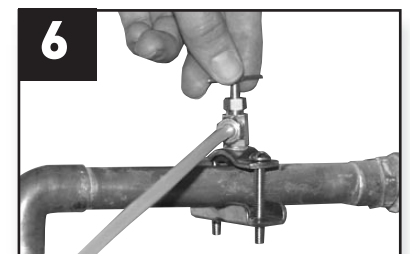

6 Turn on water source and monitor water level to ensure float valve is operating correctly. Turn on pump to resume normal Skimmerfilter™ operation.